

# GUN DEFENDER™ - BED MOUNT

## INSTRUCTIONS

### READ ALL INSTRUCTIONS BEFORE PROCEEDING

*Make sure key is in the off position and the vehicle is in park and/or parking brake engaged.  
Use wheel chocks in front and behind the rear wheels during installation procedure.*

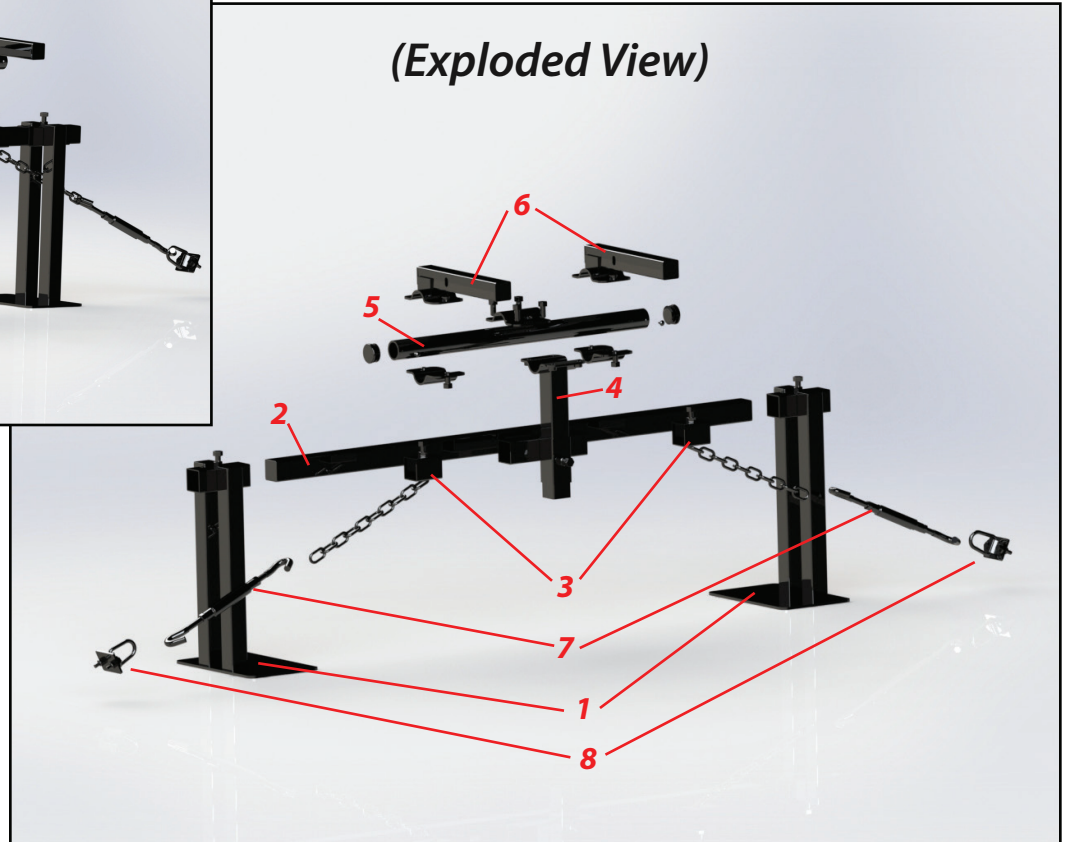
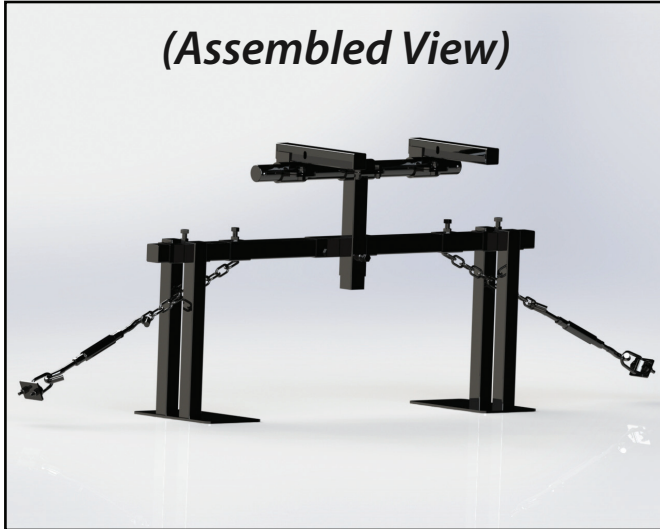

### 1. Locate Desired Mounting Location

The UTV Bed Mount can be mounted on stock vehicle anchor points or on provided bed anchors. Provided bed anchors can be installed anywhere near the bottom outside edge of the bed (just like most stock anchors). Some drilling will be required to provide holes for the provided anchors.

### 2. Assemble Components

Assemble the mount as shown in the picture and as appropriate to fit your UTV. The jam bolts attached to each component should be tightened snug to help lock the mount in position. The two mounting point bars and center pillar should also be tightened snug. **Make sure the two slider pieces are placed on the inside of the two foot pillars.**

### INCLUDED IN THIS KIT

- 1** (2) Foot Pillars
- 2** (1) Cross Bar
- 3** (2) Slider Pieces
- 4** (1) Center Pillar
- 5** (1) Upper Cross Bar
- 6** (2) Mounting Point Slider Bar
- 7** (2) Turnbuckles
- 8** (2) Bed anchors

# GUN DEFENDER™- BED MOUNT

## INSTRUCTIONS (Continued)

### 3. Mount Turnbuckles to Anchor Points

The chains attached to the slider pieces will need to be attached to one end of each provided turnbuckle. Feed the turnbuckle and chain through the foot pillar on each side. Attach the other end of the turnbuckle to the anchorpoint. **Twist the center portion of the turnbuckle to tighten or loosen it.** Tighten until there is firm tension between the mount and the anchor point. **Do not over-tighten.**



### 4. Attach Gun Defender™ to the Mount

The Gun Defender™ slides on and off the mounting point bars easily and locks in place with the provided pin. When you have Gun Defender™ in position on to the mounting point slider, slide the pin through the holes in the Gun Defender™ and through the holes in the mounting point bar. Lock the pin in place with the latch attached to the pin.

